

## Receptacles for connector

### Special Applications

Figure	Part number	Wire size mm <sup>2</sup> (AWG)	Ø Insulation (mm)	Material		Material thickness (mm)	Winding number
				Bronze 30	Bronze Pre-Sn 31		
SEAL							
	<b>8601.**</b>	<b>0,5-0,75</b> (20-18)	3,4 SEAL	•	•	0,25	4000
	<b>8603.**</b>	<b>1-1,5</b> (18-16)		•	•		
Standard Terminal							
	<b>8621.**</b>	<b>0,5-0,75</b> (20-18)	1,5-1,9	•	•	0,25	6500
	<b>8623.**</b>	<b>0,75-1</b> (18)	1,9-2,4	•	•		
	<b>8625.**</b>	<b>1-1,5</b> (18-16)		•	•		
Polarized							
	<b>8627.**</b>	<b>0,5-0,75</b> (20-18)	1,5-1,9		•	0,25	5500
	<b>8629.**</b>	<b>0,75-1</b> (18)	1,9-2,4		•		5000
	<b>8631.**</b>	<b>1-1,5</b> (18-16)			•		
Side locking							
	<b>8633.**</b>	<b>0,5-1</b> (20-18)	1,5-2,1		•	0,25	8000
	<b>8607.**</b>	<b>1,5-1,75</b> (16-14)	1,9-2,4		•		6500
	<b>8609.**</b>	<b>2,5</b> (14)			•		6000

## Receptacles for connector

### Receptacles for connector

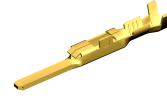

Figure	Part number	Wire size mm <sup>2</sup> (AWG)	Ø Insulation (mm)	For male (mm)	Brass	Brass Pre-Sn	Bronze	Bronze Pre-Sn	Material thickness (mm)	Winding number	
					00	01	30	31			
	One key										
	<b>4487.**</b>	=<0,5 (=<20)	=<1,6	1,6x0,8	•	•	•	•	0,25	9000	
<b>4489.**</b>	<b>0,75-1,25</b> (18-16)	=<2,4	•		•	•	•	6000			
	Two keys										
	<b>4491.**</b>	=<0,5 (=<20)	=<1,6	1,6x0,8	•	•	•	•	0,25	9000	
<b>4493.**</b>	<b>0,75-1,25</b> (18-16)	=<2,4	•		•	•	•	6000			

## Males for connector

### Tabs for connector

Figure	Part number	Wire size mm <sup>2</sup> (AWG)	Ø Insulation (mm)	Tongue thickness (mm)	Brass	Brass Pre-Sn	Bronze	Bronze Pre-Sn	Material thickness (mm)	Winding number
					00	01	30	31		
	<b>6487.**</b>	<b>=&lt;0,5</b> (=<20)	<b>=&lt;1,6</b>	0,8	•	•	•	•	0,25	9000
	<b>6489.**</b>	<b>0,75-1,25</b> (18-16)	<b>=&lt;2,4</b>		•	•	•	•		6000
	<b>6490.**</b>	<b>0,75-1</b> (18)	3,4 SEAL	0,8	•	•	•	0,4	3500	
	<b>6491.**</b>	<b>1,5</b> (16)			•	•	•			
	<b>6486.**</b>	<b>0,75-1</b> (18)	2,2 Max	0,8	•	•	•	0,4	5500	
	<b>6488.**</b>	<b>1,5</b> (16)			•	•	•		3500	



## Receptacles for connector

Receptacles for connector

Figure	Part number	Wire size mm <sup>2</sup> (AWG)	Ø Insulation (mm)	For male (mm)	Brass	Brass Pre-Sn	Bronze	Bronze Pre-Sn	Material thickness (mm)	Winding number
					00	01	30	31		
	<b>4450.**</b>	<b>0,5-0,85</b> (20-18)	1,4-2,1	2,3x0,65	•	•	•	•	0,25	8000
	<b>4458.**</b>	<b>1-2</b> (18-14)	2,1-2,7		•	•	•	•		6500
	<b>4452.**</b>	<b>0,5-1,25</b> (20-16)	3 SEAL	2,3x0,65	•	•	•	•	0,25	7000



## Males for connector

### Tabs for connector

Figure	Part number	Wire size mm <sup>2</sup> (AWG)	Ø Insulation (mm)	Tongue thickness (mm)	Brass	Brass Pre-Sn	Bronze	Bronze Pre-Sn	Material thickness (mm)	Winding number	
					00	01	30	31			
	<b>6450.**</b>	<b>0,5-0,85</b> (20-18)	1,4-2,1	0,65	•	•	•	•	0,3	8000	
	<b>6458.**</b>	<b>1-2</b> (18-14)	2,1-2,7		•	•	•	•		6000	
	SEAL										
	<b>6452.**</b>	<b>0,5-1,25</b> (20-16)	3 SEAL	0,65	•	•	•	•	0,3	7000	
	L=23.6 mm										
	<b>6454.**</b>	<b>0,5-1</b> (20-18)	1,8-2,5	0,65		•		•	0,3	5000	
<b>6455.**</b>	<b>1-2</b> (18-14)	2-4			•		•	4000			



## Receptacles for connector

### Motorbike terminals

Figure	Part number	Wire size mm <sup>2</sup> (AWG)	Ø Insulation (mm)	For male (mm)	Din	Material		Material thickness (mm)	Winding number
						Brass 00	Brass Pre-Sn 01		
	<b>4303.**</b>	<b>0,5-1,5</b> (20-16)	1,5-2,1	2,8x0,5	Esp	<input checked="" type="checkbox"/>	<input checked="" type="checkbox"/>	0,25	5000

Side feed receptacles

## Males for connector

### Motorbike terminals

Figure	Part number	Wire size mm <sup>2</sup> (AWG)	Ø Insulation (mm)	Tongue thickness (mm)	Material		Material thickness (mm)	Winding number
					Brass 00	Brass Sn 02		
	<b>6405.**</b>	<b>0,5-1,5</b> (20-16)	2-3,3	0,5	<input checked="" type="checkbox"/>	<input checked="" type="checkbox"/>	0,5	9000